



Moorland Heights

Denbury Road, Ogwell South Devon TQ12



BEST GAPP



SKYFALL



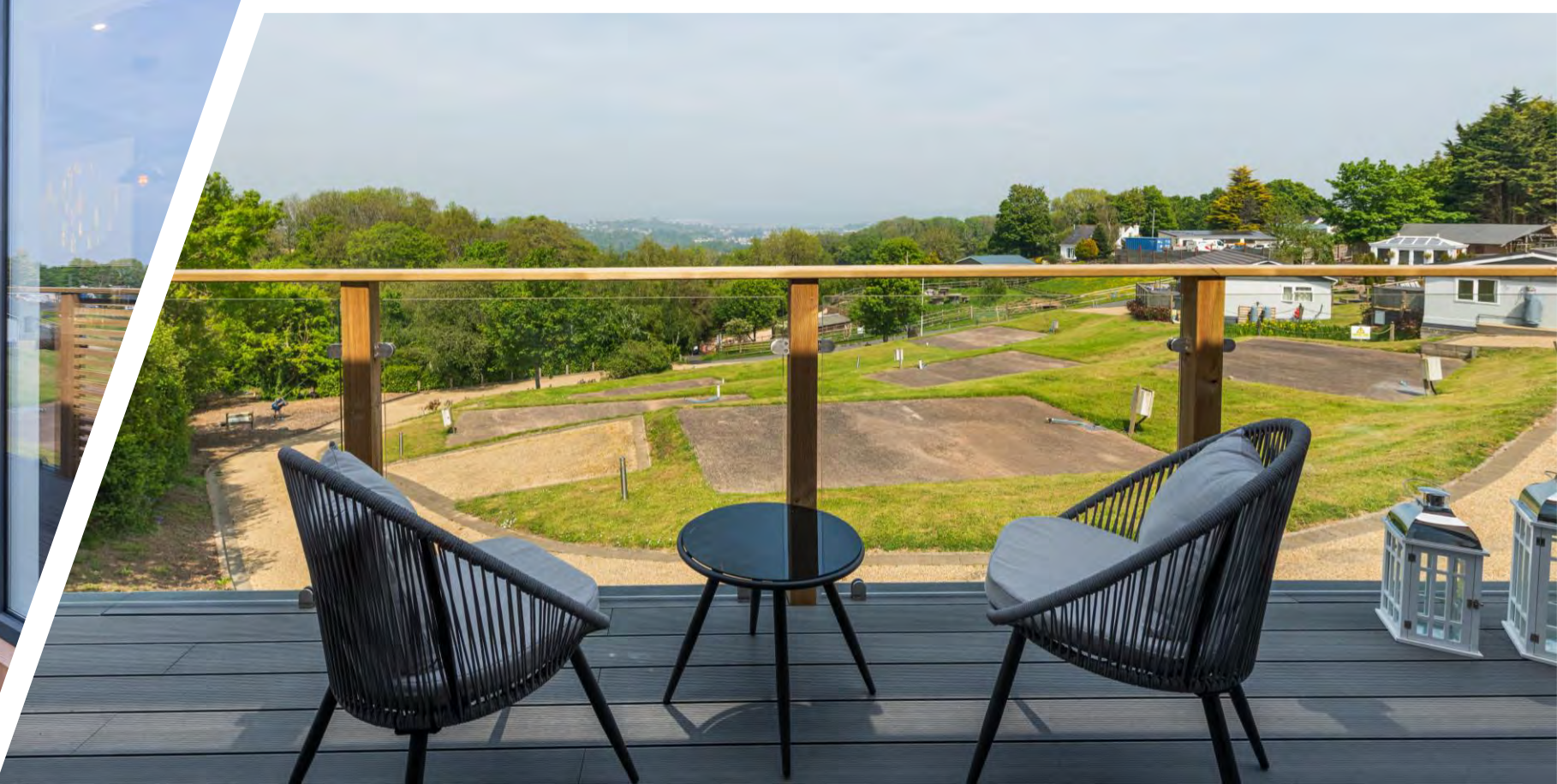



Crafted with comfort and style in mind 'Skyfall Lodge' boasts luxury living.

This newly developed luxury lodge part of the Moorland Heights Estate is ideally located between the South Devon Coast and the rolling hills of the beautiful Dartmoor National Park, suited to those looking for a perfect retreat to explore the stunning Devon countryside and coastline.

The two bedroom lodge has been meticulously designed to create a comfortable indoor-outdoor feel throughout, including a sociable open-plan living space with lounge, dining and kitchen areas giving direct access to the terrace with incredible uninterrupted views over Dartmoor National Park.







Both bedrooms have been thoughtfully arranged to create a restful and relaxing retreat with contemporary bathrooms offering an oasis of calm to unwind.

All rooms are beautifully interior designed with a colour scheme of soft natural colours and individual character. Both welcoming and comfortable.





Structure

- Built to BS3632 residential standard
- Protected by a 10-year structural guarantee
- UPVC double glazing with 10-year frame warranty and 2-year warranty
- Cedarwood cladding

Interior Features

- Spacious, open plan living space
- Two Master Bedroom Suites
- Fully fitted kitchen with integrated appliances (Fridge freezer, washing machine & dishwasher)
- 65" Flatscreen TV
- Integrated surround sound system
- Morso Wood burning stove in reception room

External Features

- Front decked terrace
- Rear large decked terrace
- Hot tub (8 persons)
- Lounge Deck Furniture
- Whistler BBQ & Wine Cooler
- Fully double glazed UPVC windows through out

PLOT 11 - 44 x 22 (2 BEDROOM) 968 sq ft (89.9 sq m)

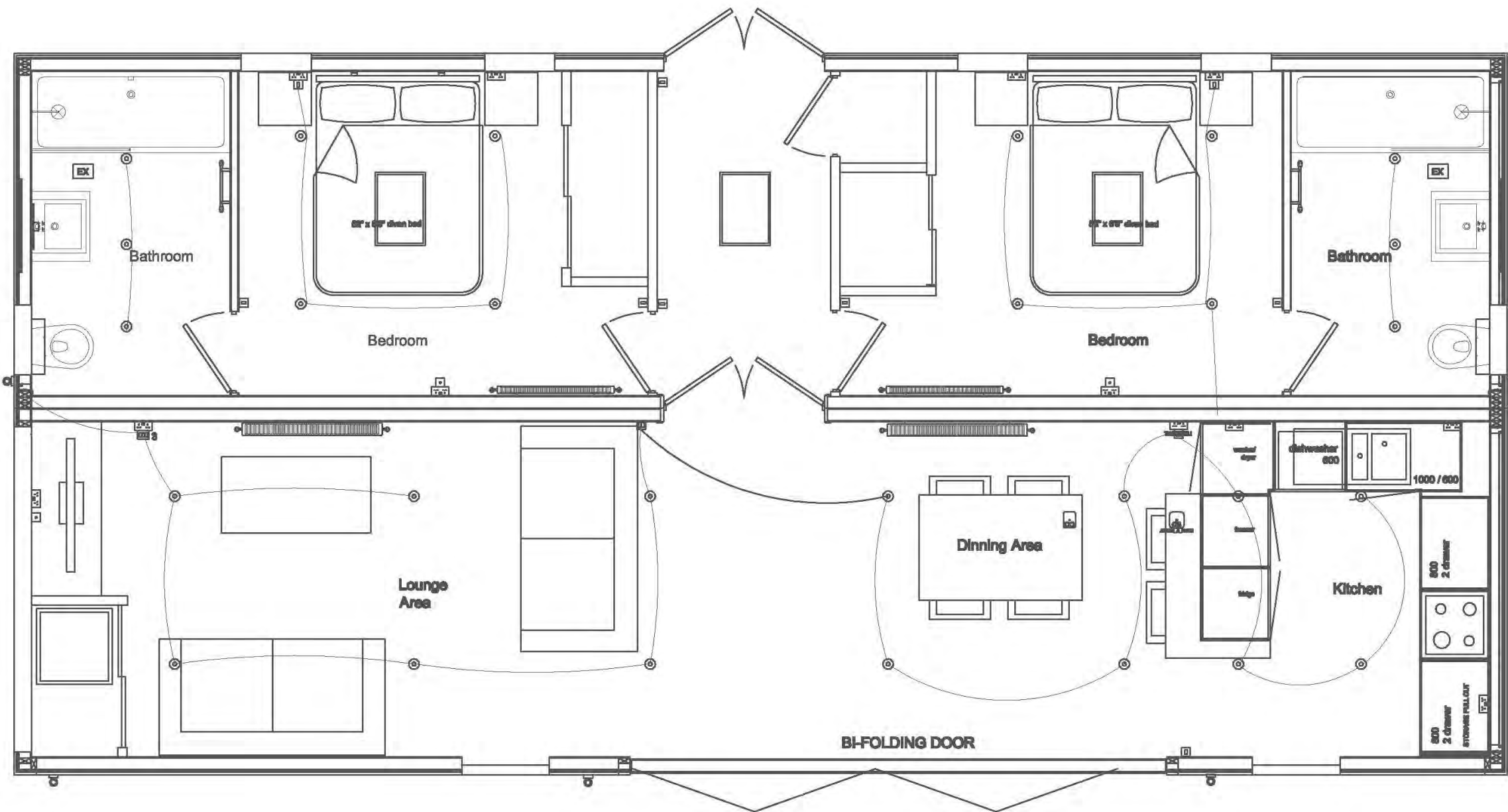



Agents notes:

Ground Rent includes:

All external maintenance, water supply and foul drainage

Access is available to the lodge all year round

Two private parking spaces alongside the lodge

Additional parking available for visitors

Location:

Within 5 minutes from excellent road and rail links at Newton Abbott with all the local amenities and Racecourse. Exeter can be easily accessed via the A380 and Plymouth via the A38 and the Dartmoor National Park, local beaches and South Devon's many beauty spots are all within easy reach of this superb lodge.

Tenure: Leasehold 125 years

Asking Price: £749,995 subject to contract

Ground Rent : £9,000 per annum

Local Authority: Teignbridge District Council



Misrepresentation Act 1967

The information in this publication should be referred solely as a general guide. Whilst care has been taken in its preparation, no representation is made nor responsibility accepted for the whole or any part. All descriptions, dimensions, reference to condition and other details are believed to be correct but intending purchasers should satisfy themselves by inspection or otherwise as to the correctness of each of them.